

Note: If you use another new HK6 hardwire cable, please reset the camera to the default setting to ensure it pairs with the new accessory.

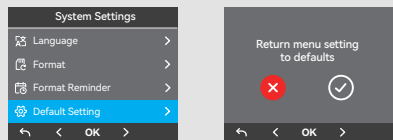

- Connect to Fuse Box

Make sure the engine and accessory power are off before proceeding.

Note: Professional installation is recommended. Do not cover HK6 with car carpet. Mount it in an open space!

1 Locate your fuse box

Fuse boxes and fuse types vary not only between car models, but also on year and variant. Check the Car Manual to find the fuse box location and confirm the fuse type.

2 Identify which fuse is ACC & Battery+

- Battery+ Wire (RED)
To identify a fuse for Battery+ connection, turn the ignition switch to the off position. Look for a fuse that is energized (allows electricity to flow) even when the ignition switch is in the off position. You can identify the fuse by applying a fuse / circuit / voltage test device when the engine is off. Place the tip of the tester on the exposed metal part of the fuse.

- ACC Wire (YELLOW)
To identify a fuse for the ACC connection, turn the ignition switch to the ACC (Accessory) position. Look for a fuse that is energized when the ignition switch is in the ACC position but is off when the ignition switch is in the off position.

3 Locate a ground point

To identify a suitable ground point, use a circuit tester in continuity mode. Locate a screw with direct connection to the vehicle chassis and check for a good continuity reading between the screw and the vehicle chassis. This should be < 0.1 ohm.

4 Connect an Add-A-Fuse cable to the hardwire cable

Use an Add-A-Fuse cable (sold separately) for a clean installation. Once the required fuse slot and type of fuse for the hardwire cable are determined, a suitable Add-A-Fuse cable can be crimped to the hardwire cable's ACC and Battery+ connections. The crimp can be made successfully using either a standard crimp tool or standard needle nose pliers.

Note: Fuse boxes and fuse types vary not only between car models, but also on year and variant. Check the Car Manual to find the fuse box location and confirm the fuse type.

5 Connect the fuses

Yellow (ACC) accessory power supply — Connect to a fuse that turns on and off with the engine.
Red (Battery+) constant power supply — Connect to a fuse that is always powered. The connection must be made after passing through the fuse.
Black (Ground) connection — Place the spade connector

under the head of a ground point screw or bolt, ensuring a clean electrical contact. Then tighten the screw to secure it.

6 Confirm proper operation

After wiring power and ground connections (Red, Yellow, Black), plug the HK6 into the dashcam and start the vehicle engine to confirm operation. Also, check parking mode settings in the VIOFO APP.

Note: We recommend testing the HK6 and dashcam (by switching to parking mode with the engine off, then resuming normal recording with the engine on) before securing cables behind the vehicle trim, because it's easier to troubleshoot when wires are accessible.

Important Notice & Disclaimer

1. If you're using multiple HK6 hardwire cables in your vehicle or replacing an existing one, ensure that only one HK6 is connected to the fuse box during installation. After installing the camera, reset it to factory settings so it can properly detect and connect to the available HK6 upon restarting.
2. When installing a second HK6 for another VIOFO camera, disconnect the original HK6 and power off all VIOFO dashcams in the vehicle. Connect the new HK6 to the fuse box and install the new camera. Once the new camera powers on, reset it to factory settings to ensure proper HK6 detection. Finally, reconnect the original HK6 and power on the original camera.

3. VIOFO shall not be held liable for any damage, injury, loss of data, or loss of property arising from the improper use, installation, or handling of this product. Use this product only as instructed in the manual. Modifying or using the product outside its intended purpose may void the warranty and cause personal injury or property damage.

Customer Service

- ✓ 12-month limited warranty
- 📞 Lifetime technical support
- ✉ support@viofo.com
- 🌐 www.facebook.com/viofo
- 📞 +1 323 505 9898 (USA)
+1 323 609 9898 (Global)
- 🕒 Mon-Fri 9am-6pm



Scan the QR code to submit a ticket

HK6 Hardwire Cable

VIOFO USB Type-C Dash Cam

USER MANUAL

Copyright (c) 2025, VIOFO Ltd, All rights reserved

HK6 Hardwire Cable

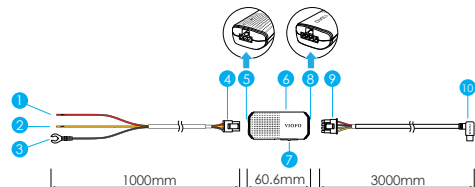

1. Battery+ (Red)
2. ACC (Yellow)
3. Ground (Black)
4. Input Connector
5. Power Input
6. Hardwire Box
7. Voltage Cut-Off Switch
8. Power Output
9. Output Connector
10. USB Type-C Plug

Battery+ : Constant power fuse slot
ACC: Switched fuse slot
Ground: ↓

Specifications

Total Cable Length: 4 Meters (13 Feet)

Input: 12-24V DC

Output: USB Type-C, DC 5V3A

Battery Protection Options: 11.8V / 12.0V / 12.2V / 12.4V
 23.6V / 24.0V / 24.4V / 24.8V

Working temperature: -30°C to 60°C (-22°F to 140°F)

Protection: Low Voltage Protection, Over Current / Surge Protection, Reverse Polarity Protection

Features

The HK6 provides continuous power to the dashcam for parking mode. The ACC detection function will switch the dashcam into parking mode automatically when the vehicle engine is shut off, and will resume normal recording when the engine is restarted. The Low Voltage Cut-off function will protect the vehicle battery from excessive discharge.

	Supports 12-24V Electrical Systems
	4 Options for Voltage Cut-off to Prevent Battery Drain
ACC	ACC Detection, Automatically Switches Parking Mode
	Constant Power Supply
	Compatible with VIOFO Dashcam with Type-C Power Input; Supports Vehicle Battery Monitoring

Functions

1 Low voltage battery protection function of the HK6

The low voltage cut-off is built into the HK6 and can be set via the slide switch. When the vehicle is turned off, the HK6 will monitor vehicle battery voltage, and stop powering the dashcam when voltage remains below the set value for more than 90 (±10) seconds. This will protect the battery from excess discharge.

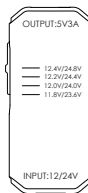

2 Vehicle battery voltage monitoring for A329S Series

When the HK6 is powered on, the dashcam will detect it on startup, and display: "Discovered the Hardwire cable. HK6-xxxxxxx". The HK6 will continuously monitor battery voltage shown in the lower-left corner of the video. Currently, only the A329S Series supports voltage monitoring with HK6.



3 Hybrid parking mode for A329S Series

Cut-off Voltage is only available with HK6. In hybrid parking mode, when Cut-off Voltage is set, the dashcam switches to low power impact detection mode when the vehicle battery reaches Cut-off Voltage.

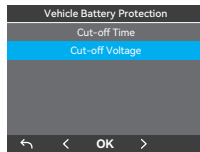

Installation Steps

- HK6 Assembly

Please take note of connector orientation to assemble HK6 properly. The hardwire box is detachable for easy troubleshooting.

1 Insert the output connector into the power output.

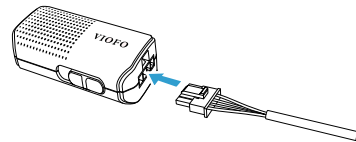

2 Insert the input connector into the power input.

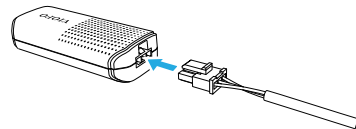

3 Plug Type-C cable to the dashcam.

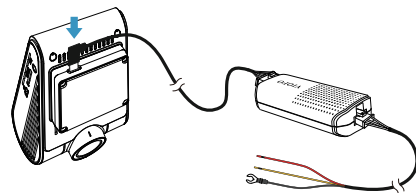

Scan the QR code or search the link to watch the installation guide.



<https://www.viofo.com/blogs/viofo-car-dash-camera-guide-faq-and-news/how-to-install-the-hardwire-kit-a-step-by-step-guide>

The user manual is available on <https://www.viofo.com/pages/support>